

57 EDGEHILL PLACE

Approximate Gross Internal Area
344 sq ft / 32.0 sq m

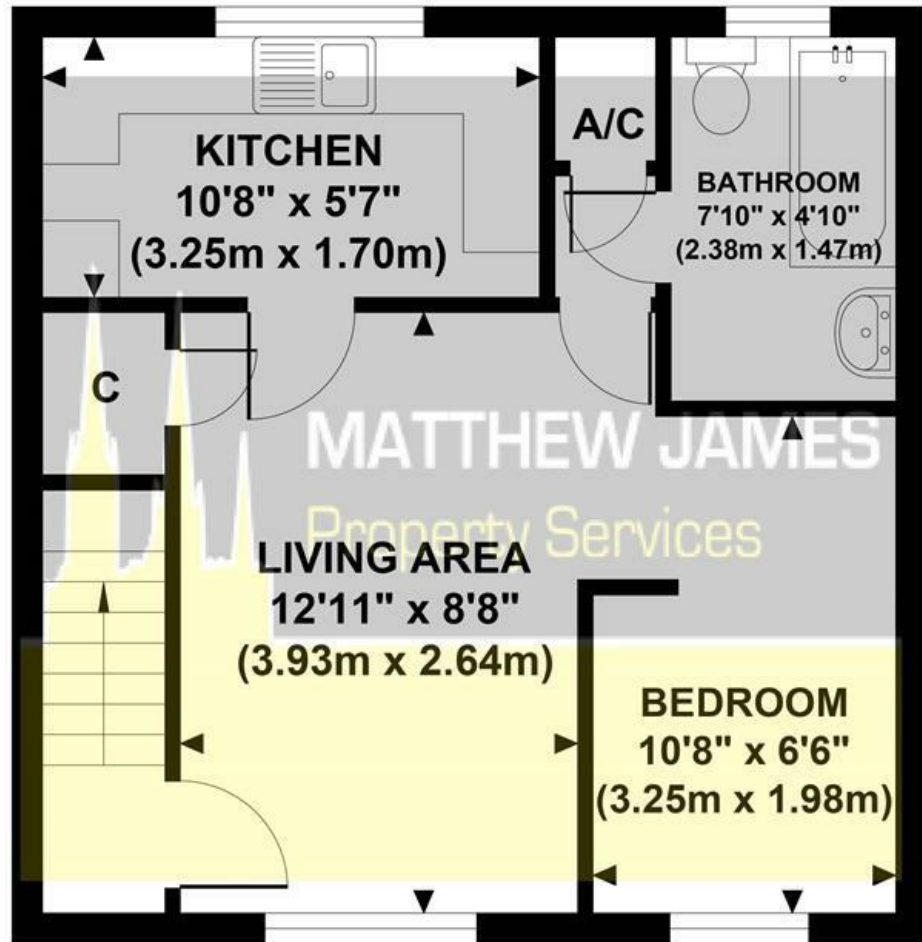

GROSS INTERNAL FLOOR AREA 344 SQ FT

Although every attempt has been made to ensure accuracy, all measurements are approximate and no responsibility is taken for any error, omission, or mid-statement. This floor plan is for illustrative purposes only and not to scale. Measured in accordance to RICS standards.

These particulars, whilst believed to be accurate are set out as a general outline only for guidance and do not constitute any part of an offer or contract. Intending purchasers should not rely on them as statements of representation of fact, but must satisfy themselves by inspection or otherwise as to their accuracy. No person in this firm's employment has the authority to make or give any representation or warranty in respect of the property.

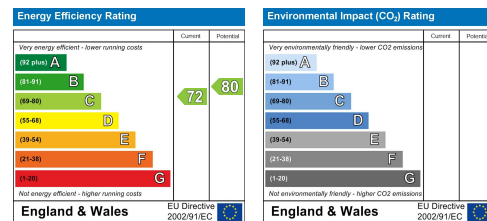

57 Edgehill Place

Tanyard Farm, Coventry CV4 9UE

FIRST FLOOR MAISONETTE... OPEN PLAN BEDROOM... WORCESTER BOSCH CENTRAL HEATING... PVCU DOUBLE GLAZING... VACANT... NO UPWARD CHAIN... NEW 125 YEAR LEASE UPON COMPLETION... GREAT INVESTMENT PURCHASE... PERFECT FOR THE FIRST TIME BUYER OR THOSE LOOKING TO DOWNSIZE. Located on the popular Tanyard Farm estate, this property located on the first floor really does need to be viewed to appreciate what is being offered for sale. Benefiting from being vacant and having no upward chain, it would be perfect for those looking to expand their property portfolio, looking to downsize or the first time buyer. Having an open plan bedroom, living area, family bathroom, storage cupboard and fitted kitchen. In need of a little TLC, why not come and take a look and book your immediate viewing now.

£65,000

CONTACT INFORMATION

24a Warwick Row, Coventry CV1 1EY

02477 170170

info@matthewjames.uk.com

www.matthewjames.uk.com

Facebook

Twitter

MATTHEW JAMES
Property Services

57 Edgehill Place

Tanyard Farm, Coventry CV4 9UE



- **FIRST FLOOR**
- OPEN PLAN LIVING
- GREAT INVESTMENT PROPERTY
- VACANT
- WORCESTER BOSCH CENTRAL HEATING
- PVCU DOUBLE GLAZING

- 125 YEAR LEASE UPON COMPLETION
- NO UPWARD CHAIN



Entrance Hallway

Living Area

12'11 x 8'8 (3.94m x 2.64m)

Open Plan Bedroom

10'8 x 6'6 (3.25m x 1.98m)

Family Bathroom

7'10 x 4'10 (2.39m x 1.47m)

Kitchen

10'8 x 5'7 (3.25m x 1.70m)



Directions

